

MULTI-FAMILY DEVELOPMENT

WESTBOURNE CONDOMINIUMS INDIANAPOLIS, INDIANA

Description:

Site design of a condominium development containing 80 townhome units on 10.8 acres in Indianapolis.

Services Provided:

- *Site Feasibility & Due Diligence*
- *Land Planning*
- *Surveying*
- *Site Design / Civil Engineering*
- *Drainage Design*
- *Permitting*
- *Project Coordination*



Notable Characteristics:

- *The location chosen for the Westbourne Condominium project was in a high-traffic / high visibility area, taking advantage of the nearby amenities. The project was zoned as a planned development and as a result included*

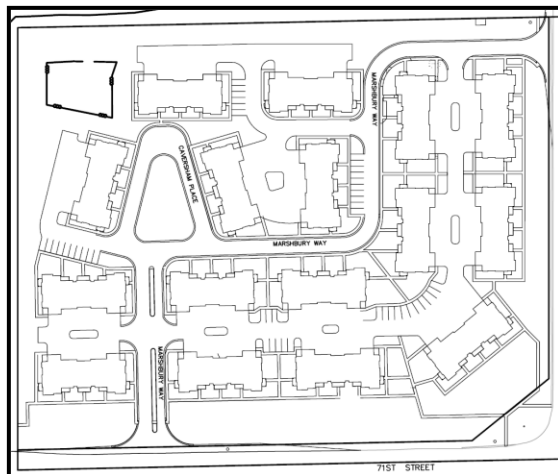

private streets with various setbacks in order to achieve a town feel. Roger Ward Engineering worked closely with the developer, the City of Indianapolis to obtain the necessary approvals and achieve the desired density.

